

ERGOPLUS 36



CE EN60974-7



CODE	↔	
------	---	--

MA7443	3 m	10'	
MA7444	4 m	12'	
MA7445	5 m	16.4'	

TECHNICAL DATA		
----------------	--	--

	1,6 kg	3,53 lb
V PEAK	113	
	0,6 ÷ 1,6 mm	.023" ÷ 1/16"
X 60%	340A CO2 - 320A Mix	

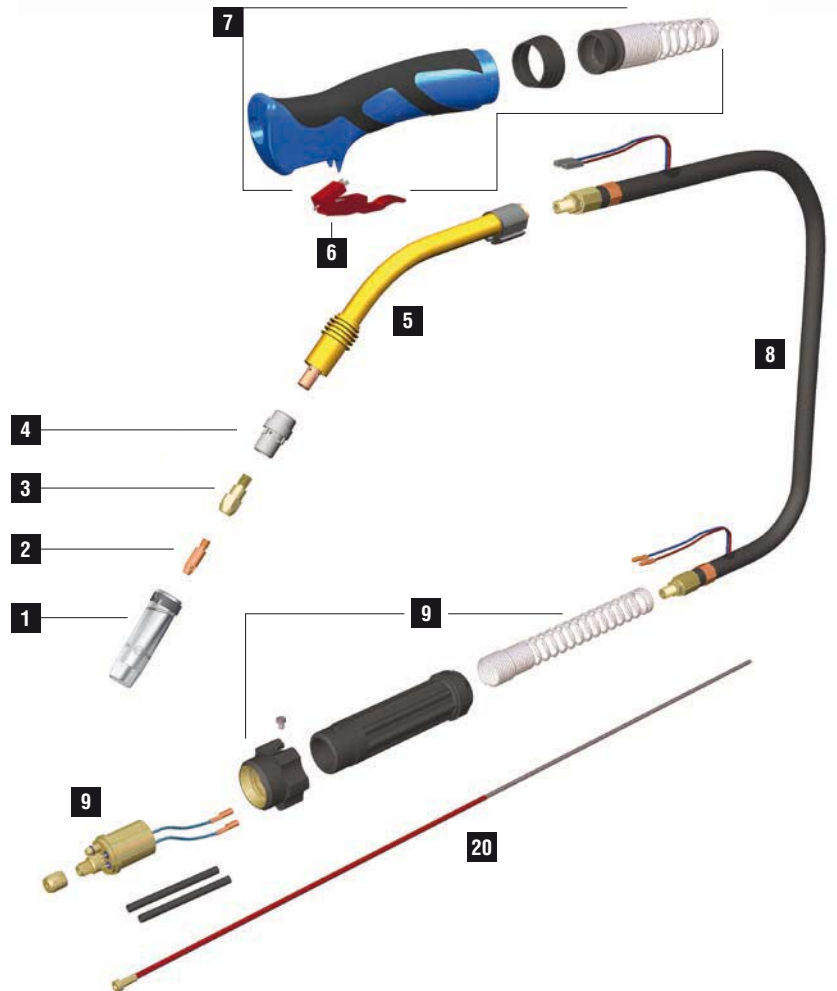

	CODE			Ø			REF		
1	MC0026		2,5 mm	12 mm	1/2"	84 mm	145.0126	10	
1	MC0027		2,5 mm	16 mm	5/8"	84 mm	145.0078	10	
1	MC0028		2,5 mm	19 mm	3/4"	84 mm	145.0045	10	
1	MC0109		2,5 mm	17 mm		84 mm	-	10	
1	MC0110		2,5 mm	20 mm		90 mm	145.0172	10	
1	MC0440		light 2 mm	16 mm	5/8"	84 mm		10	
1	MC0527		quick release 2,5 mm	16 mm	5/8"	84 mm	-	10	
1	MC0540		quick release - light 2 mm	16 mm	5/8"	84 mm	-	10	
2	MD0009-76		M6 - CuCrZr	0,6 mm	.023"	28 mm	-	20	
2	MD0009-78		M6 - CuCrZr	0,8 mm	.030"	28 mm	140.0054	20	
2	MD0009-80		M6 - CuCrZr	1,0 mm	.040"	28 mm	140.0245	20	
2	MD0009-82		M6 - CuCrZr	1,2 mm	.045"	28 mm	140.0382	20	
2	MD0009-84		M6 - CuCrZr	1,4 mm	.052"	28 mm	-	20	
2	MD0009-86		M6 - CuCrZr	1,6 mm	1/16"	28 mm	-	20	
3	MD0063-00		M6 - brass			28 mm	142.0005	20	
3	MD0131-00		M6 - brass			32 mm	142.0011	20	
4	ME0017		plastic			32,8 mm	014.0261	10	
4	ME0041		plastic			32,8 mm	014.0021	10	
4	ME0417		plastic compound high tech			32,8 mm	-	10	
4	ME0517		ceramic			32,8 mm	014.0023	10	
20	GM0510		red steel liner	1,0 ÷ 1,2 mm	.040" ÷ .045"	3 m	10'	124.0026	1
20	GM0511		red steel liner	1,0 ÷ 1,2 mm	.040" ÷ .045"	4 m	12'	124.0031	1
20	GM0512		red steel liner	1,0 ÷ 1,2 mm	.040" ÷ .045"	5 m	16.4'	124.0035	1

	CODE			
5	MF0034		mig torch head	1
6	BX0024		trigger	
7	MT0237			1
8	MH0120		3 m - 10' - 50 mm ²	
8	MH0127		4 m - 12' - 50 mm ²	

	CODE			
8	MH0128		5 m - 16.4' - 50 mm ²	
9	AR0070		EURO connection	1
9	BW0020		Euro nut metal	
9	FA0026		liner nut M10X1	
9	MT0229		Back box kit euro	1

STANDARD

FOR ALL CONSUMABLES SEE PAGE 294

ERGOPLUS 36 M8 YELLOW LINER



CODE	↔	
------	---	--

MA7446	3 m	10'	EURO
MA7447	4 m	12'	
MA7448	5 m	16.4'	

MA7490T	3 m	10'	TWECO®
MA7491T	4 m	12'	
MA7492T	5 m	16.4'	

MA7490M	3 m	10'	MILLER®
MA7491M	4 m	12'	
MA7492M	5 m	16.4'	

MA7490L	3 m	10'	LINCOLN®
MA7491L	4 m	12'	
MA7492L	5 m	16.4'	

CODE	↔	
------	---	--

MA7490	3 m	10'	5/8-18 UNF
MA7491	4 m	12'	
MA7492	5 m	16.4'	

+	
AR0170	Tweco® 1/4 KIT
AR0172	Lincoln® KIT
AR0173	Miller® KIT
KIT to be assembled by a qualified technician	

TECHNICAL DATA		
----------------	--	--

	1,6 kg	3,53 lb
V PEAK	113	
	0,6 ÷ 1,6 mm	.023" ÷ 1/16"
X 60%	340A CO2 - 320A Mix	

